

K-HEN TO K-HIIN



THE RACE CONTINUES

Kentucky Hospital [Improvement Innovation](#) Network

K-HIIN

**Data Webinar Series
Improvement Calculator**



Kentucky
Hospital
Association

Kentucky Hospital [Improvement Innovation](#) Network

- Improvement Calculator Overview
- Extracting data from CDS
- Understanding the data in the Improvement Calculator



Kentucky Hospital [Improvement Innovation](#) Network

- A tool to assist with data analysis
 - Individual measure
 - Harm Across the Board—a method of looking at the number of Harms/Discharge
 - Utilizes data from HRET's Comprehensive Data System (CDS)
- [Instruction Manual](#)



Kentucky Hospital Improvement Innovation Network

- How to access the IC
 - [HRET HIIN Data](#) page

The screenshot displays the HRET HIIN website interface. On the left is a vertical navigation menu with the following items: Engage (orange header), Join Our HIIN, Fellowships, SNAP, LISTSERV®, UP Campaign, and News You Can Use. The main content area features a dark blue navigation bar with links for Home, About, Topics, Data (circled in red), Events, and Resources. A search bar is located on the right of this bar. Below the navigation bar is a large graphic with a word cloud containing terms like WELLNESS, FITNESS, CARE, DIETING, ENERGY, HEALTH, and HAPPINESS. At the bottom of the graphic, there is a call to action: 'Follow us on Twitter @HRETtweets!' and 'Share your stories and QI journey using #WhyImHIIN and follow us @HRETtweets' with a 'Tweet Now' button.

K-HEN TO K-HIIN



THE RACE CONTINUES

Kentucky Hospital [Improvement Innovation](#) Network

Tracking Safety Across the Board. The [HIIN Improvement Calculator](#) enables hospitals to use data collected via the Comprehensive Data System (CDS) to calculate, and track, a "total harm per discharge" rate in pursuit of safety across the board. This Excel-based tool provides a simple end-user experience and not only calculates harms per discharge, but also calculates and displays harms prevented, lives saved, and costs saved. Users should take the time to review the "[Instructions](#)" tab included directly in the tool.

Check Out the HIIN Data Tutorials! +

HIIN Improvement Calculator Data Tutorials +

Data Collection Fact Sheets +



[Download the EOM](#)

The HRET HIIN Data Team looks forward to working with you!



[NHSN Group Instructions](#)



[Watch a Past Data Webinar](#)



Kentucky
Hospital
Association

- You may either open or save the file
- It is best to start to with a blank IC each time
 - If you save it with data in the file—you MUST remove all data when adding new data
 - Suggest you download a new copy each month because of potential revisions to the IC

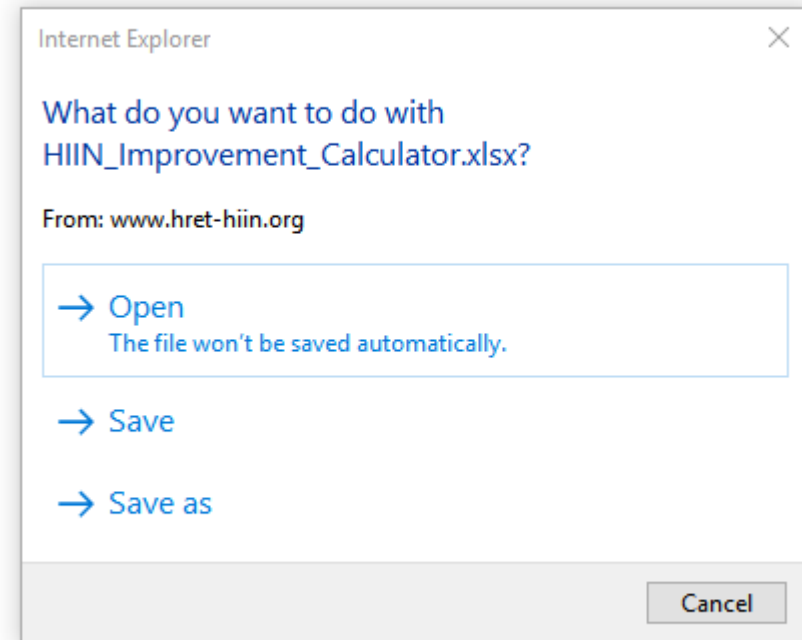

Kentucky Hospital [Improvement Innovation](#) Network

- Sharing screen to demonstrate IC and data download
- Will review the data download from the 'Instructions' tab in the IC



Kentucky Hospital Improvement Innovation Network

- Summary Table and Summary Table per Discharge
 - Use *Rate per 1000*—not just a rate
- Summary Table per Discharge
 - * footnote does not accurately reflect the results
 - If rate is 0, it is not showing the data in this table
- Dashboard—Ideally
 - Measure rate and Rate per Discharge should trend down
 - Harms Prevented and Lives Saved should trend up



K-HEN TO K-HIM



THE RACE CONTINUES

Kentucky Hospital Improvement Innovation Network

Questions



Kentucky
Hospital
Association